

EXAMPLE OF COMPLETE SKID -- THIS VERSION WITH DUPLEX CIRCULATION PUMPS AND SINGLE W/FILTER, DUPLEX CARBON MEDIA FILTRATION

CONTROL DE CALIDAD / QUALITY CONTROL	
ACTIVIDAD / ACTIVITY	RESPONSABLE / FECHA / DATE
REVISIÓN Y CONTROL DIMENSIONES / REVIEW AND DIMENSION CONTROL	
REVISIÓN Y CONTROL MATERIALES / REVIEW AND MATERIALS CONTROL	
REVISIÓN Y CONTROL SOLDADURA / WELD / REVIEW AND WELDING CONTROL	
REVISIÓN Y CONTROL PINTURA / COATING / REVIEW AND PAINTING CONTROL	
REVISIÓN Y CONTROL ENPAQUETE / PACKING / REVIEW AND PACKING CONTROL	
REVISIÓN Y CONTROL CABLEADO / WIRING / REVIEW AND WIRING CONTROL	
REVISIÓN Y CONTROL OBRAS / WORKS / REVIEW AND WORKS CONTROL	

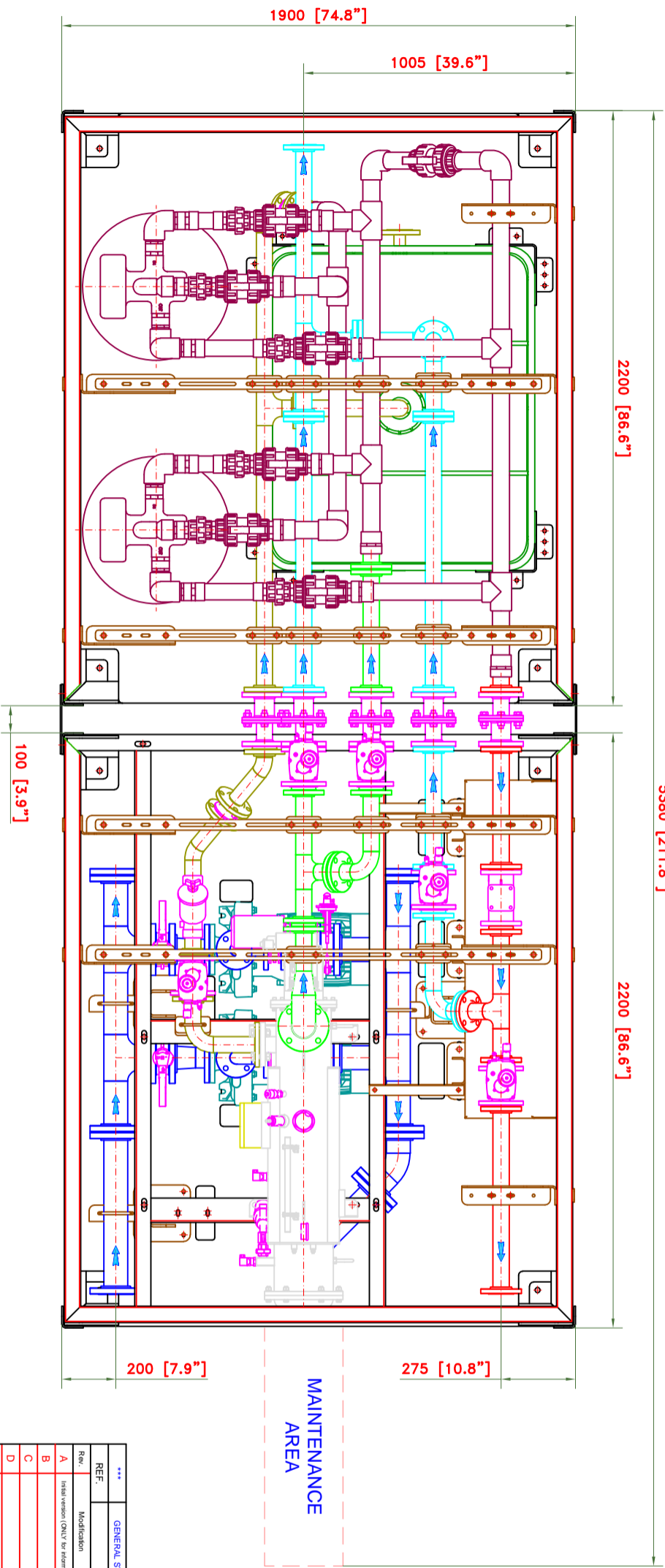
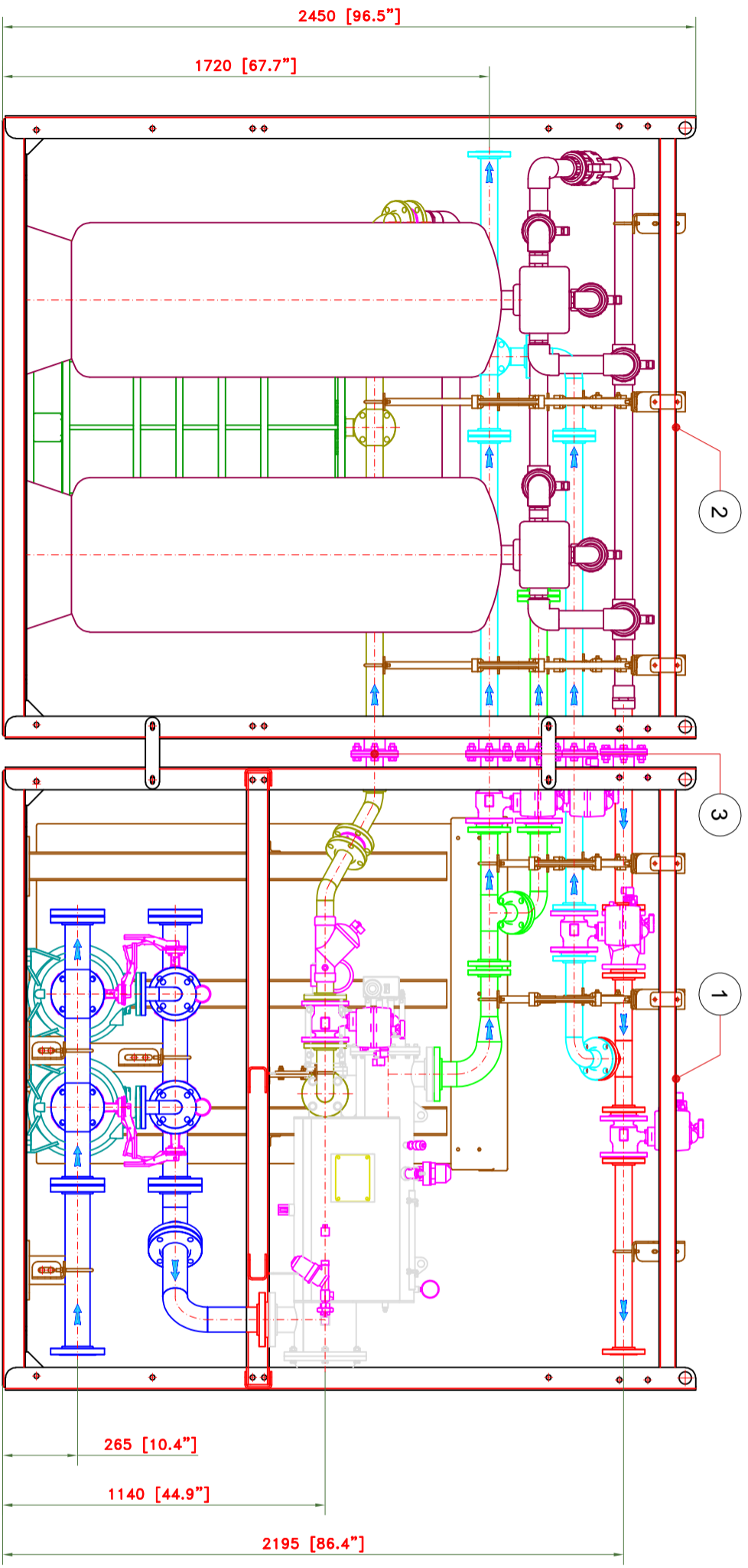

CONNECTION LIST

COLOUR	REF	INCH	DESIGNATION
Blue	Ln-1	3"	RAW WATER INLET
Red	Ln-2	2"	FILTERED WATER OUTLET
Green	Ln-3	2"	LANCASTER WATER INLET
Purple	Ln-4	2"	LANCASTER SYSTEM PIPES
Cyan	Ln-5	2"	BY-PASS LINE
Yellow	Ln-6	2"	DRAIN WATER LINE

ALL CONNECTIONS BETWEEN PIPES ARE MADE WITH SLIP-ON FLANGES, ACCORDING TO ANSI B16.5 NORM

ITEM	DESIGNATION	QUANT	MATERIAL	OBSERVATIONS
1	RAW-7000 SYSTEM WITH MANIFOLDS	1	...	DRAWING: 20xxxxx SK4A
2	LANCASTER SYSTEM WITH MANIFOLDS	1	...	DRAWING: 20xxxxx SK4B
3	WCMX TIGHT DISMANTLING JOINT	5	ANSI-304L	

REF.	DESCRIPTION	DATE	NAME	SIGNED	SCALE	OBSERVATIONS
A	Initial version (ONLY for information)		J.P.R.		1:10	
B	Modification					
C	Modification					
D	Modification					
E	Modification					
F	Modification					

CLIENT:	PROJECT:	DATE:	SCALE:
OMICRON WATER TECHNOLOGIES	STORM WATER PROJECT	05/05/20	1:10

DESCRIPTION:	DATE:	NAME:	SIGNED:
OMICRON SEQUENCE 2900UV - 50	05/05/20	J.P.R.	
Nº DRAWING	05/05/20	J.P.R.	
WORK ORDER	20xxxxx.00.00	J.P.R.	



CONTROL DE CALIDAD / QUALITY CONTROL	
ACTIVIDAD / ACTIVITY	RESPONSABLE / FECHA / DATE
REVISIÓN Y CONTROL DIMENSIONES / REVIEW AND DIMENSION CONTROL	
BOLSAQUILAJE / WELD	
GRANALLAJE / SHOT-BLASTING	
PINTURA / COATING	
EMBALAJE / PACKING	
CARGA / CHARGE	

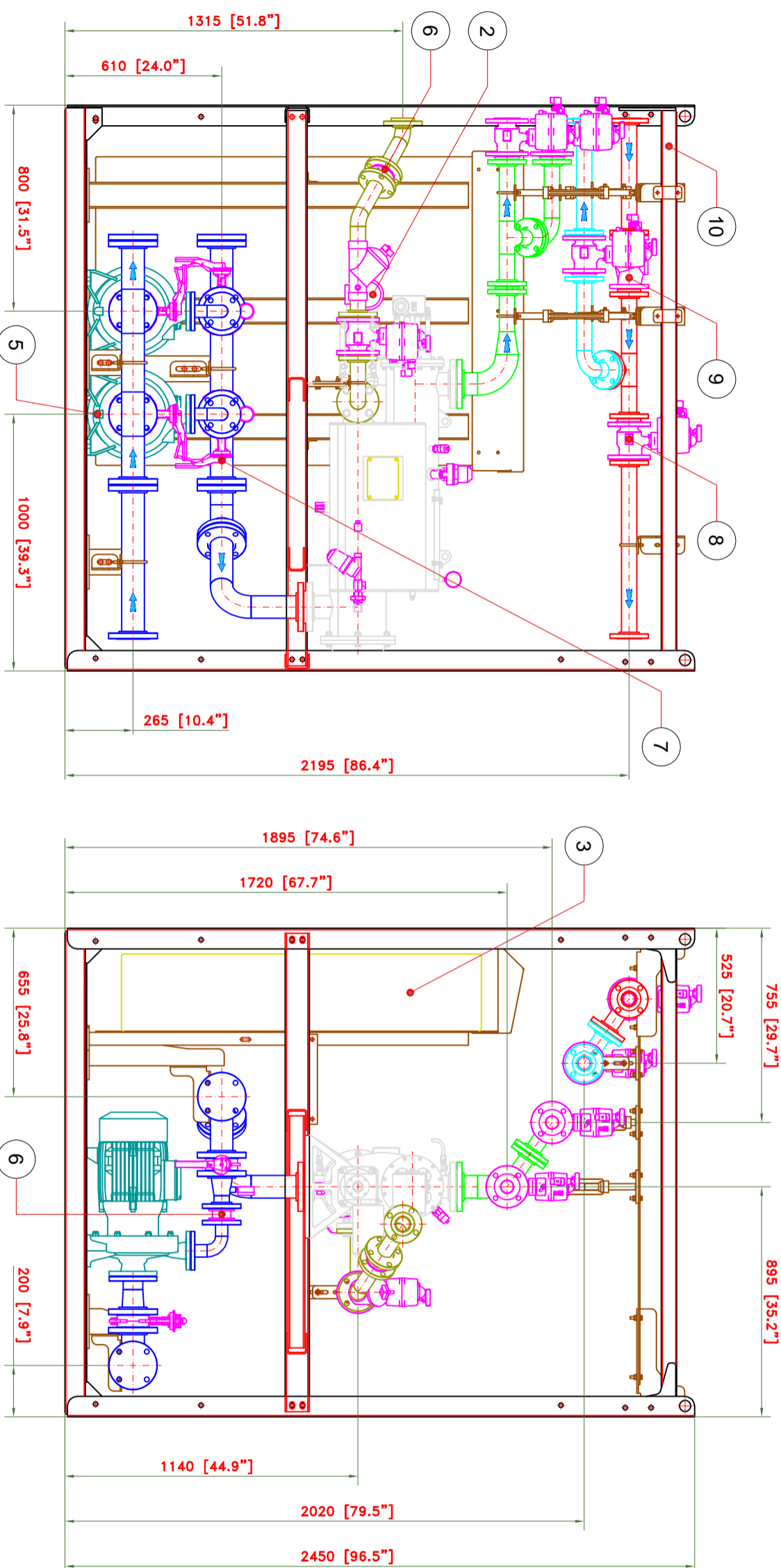

CONNECTION LIST

COLOUR	REF.	INCH	DESIGNATION
■	Ln-1	3"	RAW WATER INLET
■	Ln-2	2"	FILTERED WATER OUTLET
■	Ln-3	2"	LANCASTER WATER INLET
■	Ln-4	2"	LANCASTER SYSTEM PIPES
■	Ln-5	2"	BY-PASS LINE
■	Ln-6	2"	DRAIN WATER LINE

ALL CONNECTIONS BETWEEN PIPES ARE MADE WITH SLIP-ON FLANGES, ACCORDING WITH ANSI B16.5 NORM

ITEM	DESIGNATION	QUANT.	MATERIAL	OBSERVATIONS
1	UV AUTOMATIC FILTER FMA-7003 UV WITH INLET / OULET NOZZLES 3" x 150lbs	1	ABS-304L	
2	ELECTRIC MOTOR	1	...	
3	CONTROL PANEL	1	...	
4	BACKWASH VALVE 2" - THREADED	1	PLASTIC	BACKWASH OUTLET
5	PUMP (DN CONNECTION)	2	...	
6	DNMS INLET / DNMS OULET	3	IRON CAST	RAW WATER INLET
7	WATER CHECK VALVE 2" - 150lbs	4	IRON CAST	RAW WATER INLET
8	ELECTRIC BALL VALVE 2" - FLANGED	5	ABS-304L	
9	SLIP-ON 2" - 150 Lbs. - L= 150	1	IRON CAST	
10	SLIP-ON 2" - 150 Lbs. - L= 210	1	S-275-JR	

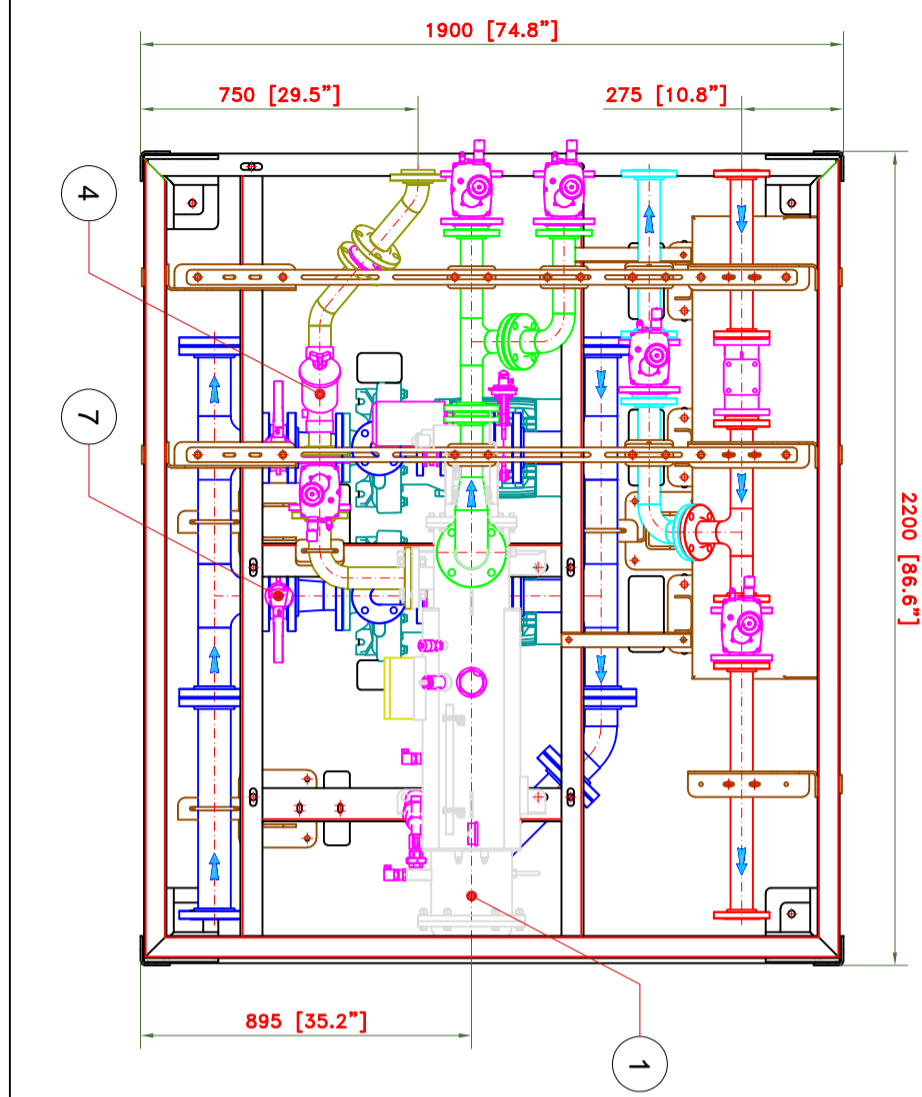

REF.	ITEM	QUANTITY	MATERIAL	WEIGHT	OBSERVATIONS
...	FMA-7003 SYSTEM WITH MANIFOLDS	1

REV.	MODIFICATION	DATE	NAME	SIGNED
A	Initial version (ONLY for information)	05/05/20	J.P.R.	[Signature]
B				
C				
D				
E				
F				

DESCRIPTION	DATE	NAME	SIGNED
OMICRON WATER TECHNOLOGIES	05/05/20	J.P.R.	[Signature]
STORM WATER PROJECT	05/05/20	J.P.R.	[Signature]
OMICRON SEQUENCE 2900UV - 50	05/05/20	J.P.R.	[Signature]
Nº DRAWING	05/05/20	J.P.R.	[Signature]
Work order nº	20xxxxx SIDA		

CONTROL DE CALIDAD / QUALITY CONTROL	
RESPONSABLE / RESPONSIBLE	
FECHA / DATE	
ACTIVIDAD / ACTIVITY	
REVISIÓN Y CONTROL DIMENSIONES / REVIEW AND DIMENSION CONTROL	
BOLSA/BLANK / WELD	
GRANALLADO / SHOT BLASTING	
PINTURA / COATING	
EMBALAJE / PACKING	
CAMBIO / CHANGE	

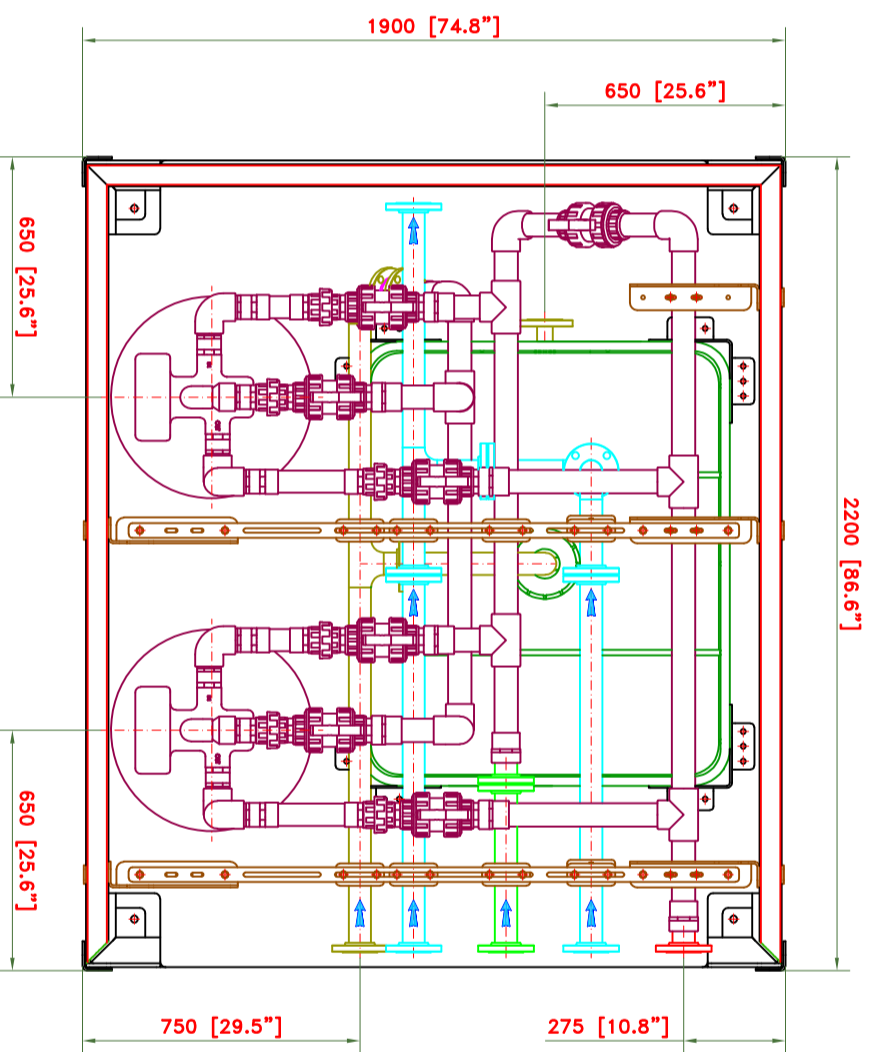
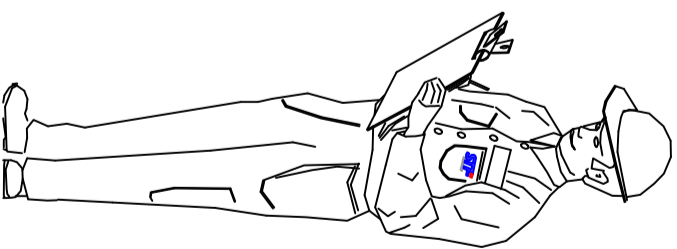
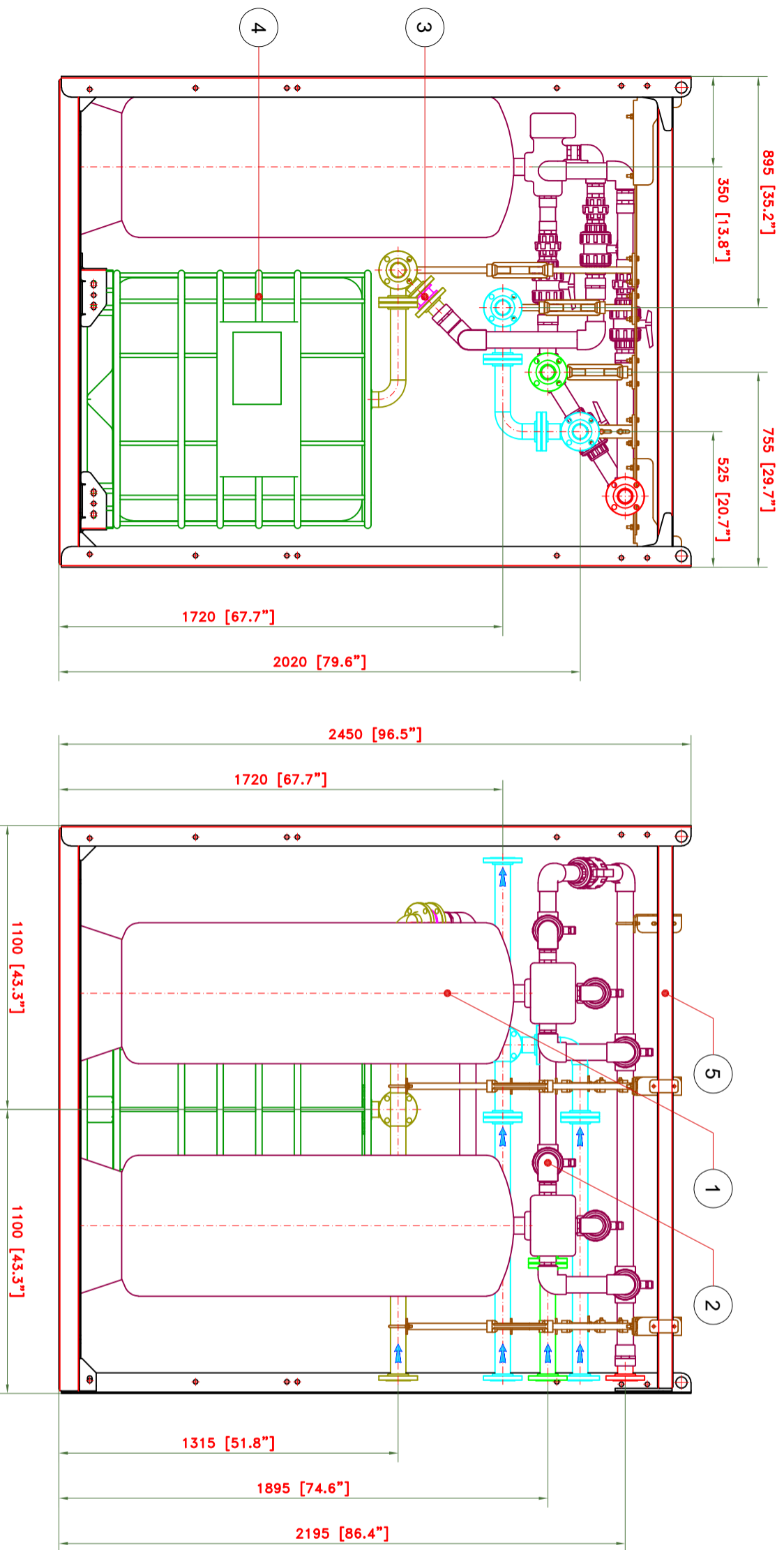

CONNECTION LIST

COLOUR	REF.	INCH	DESIGNATION
■	Ln-1	3"	RAW WATER INLET
■	Ln-2	2"	FILTERED WATER OUTLET
■	Ln-3	2"	LANCASTER WATER INLET
■	Ln-4	2"	LANCASTER SYSTEM PIPES
■	Ln-5	2"	BY-PASS LINE
■	Ln-6	2"	DRAIN WATER LINE

ALL CONNECTIONS BETWEEN PIPES ARE MADE WITH SLIP-ON FLANGES, ACCORDING WITH ANSI/B16.5 NORM.

ITEM	DESIGNATION	QUANT.	MATERIAL	OBSERVATIONS
1	CATALYTIC/HIGH ACTIVATED CARBON TANK	2	...	NOT SUPPLY BY STF
2	CATALYTIC SYSTEM PIPES	1	PVC	NOT SUPPLY BY STF
3	WATER CHECK VALVE Z - 150Lbs	1	IRON CAST	
4	IBC TANK - 1000 Bbls L=43 DIMENSIONS: 1200 X 1000 X 1160	1	PVC	
5	SKID	1	S-275-JR	

REF.	ITEM	QUANTITY	MATERIAL	WEIGHT	OBSERVATIONS
...	LANCASTER SYSTEM WITH MANIFOLDS	1

Rev.	Modification	Date	Name	Signed
A	Initial version (ONLY for information)	05/05/20	J.P.R.	J.P.R.
B				
C				
D				
E				
F				

DESCRIPTION	Scale	Date	Name	Signed
CLIENT: OMICRON WATER TECHNOLOGIES	1:10	05/05/20	J.P.R.	J.P.R.
REFERENCE: STORM WATER PROJECT				
DESCRIPTION: OMICRON SEQUENCE 2900UV - 50				
WORK ORDER: N° DRAWING	Revision	05/05/20	J.P.R.	J.P.R.
XXXX	Approved	05/05/20	J.P.R.	J.P.R.



STF